

DETAIL OF THE WALL INSULATION AROUND FLUE OUTLET ON THE BUILDING FACADE

System Solutions

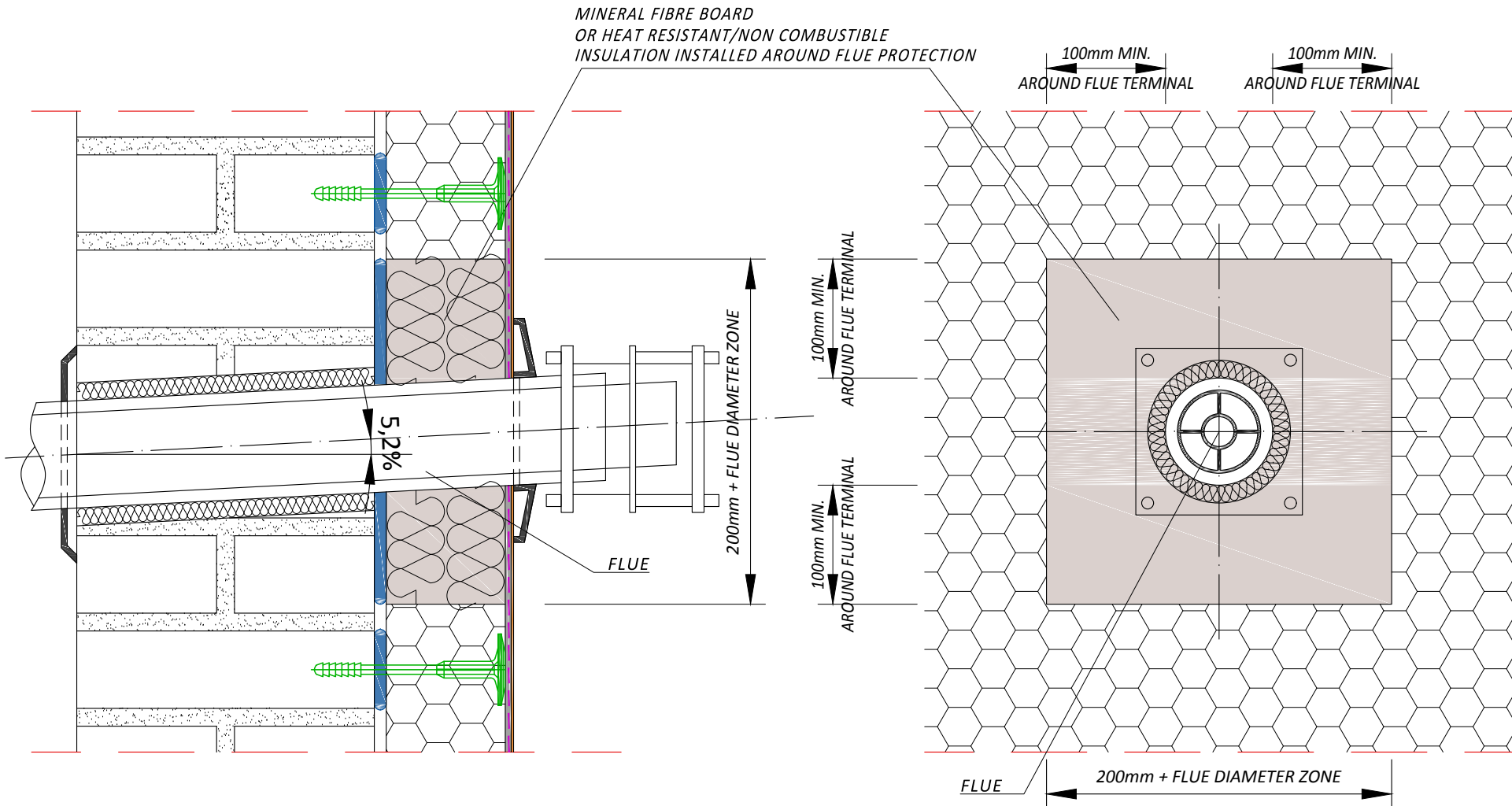

ATLAS Sp. z o.o., 91-421 Łódź, ul. Kilińskiego 2
 tel.: +48 42 631 88 00; fax: +48 42 631 88 88
 www.atlas.com.pl, e-mail: atlas@atlas.com.pl



THE INSTALLER IS RESPONSIBLE FOR A CORRECT MONTAGE OF THE OUTLET PIPE FOR FLUE GASES.
 ITS IMPLEMENTATION MUST COMPLY WITH SEPARATE REGULATIONS.
 ALL FLUES SERVING BOILERS REQUIRE 300mm MINIMUM CLEARANCE AROUND THE FLUE TERMINAL FREE FROM COMBUSTIBLE MATERIAL

NOTICE:
 THE DETAILS PROVIDED ARE INFORMATIVE AND ARE TO HELP THE DESIGNER IN SELECTING THE PROPER SOLUTIONS.
 THEY ARE NOT EXHAUSTIVE AND HAVE TO BE ADAPTED BY THE DESIGNER TO THE INDIVIDUAL CIRCUMSTANCES APPROPRIATE TO THE SPECIFIC IMPLEMENTATION

THE DRAWING IS INTENDED FOR UNITED KINGDOM ONLY

**No. 1.9.1 ATLAS ETICS
 EWI AROUND THE FLUE OUTLET**

WALL INSULATION OF THE EXISTING BUILDING
 EXAMPLARY DESIGN SOLUTION